

Whitetail Woods

Regional Park Farmington, MN

Red

Scale : 1 : 10,000
Contours : 2 meters

Base map: Dakota County Lidar data 2012
Field Survey: Kevin Teschendorf 2016, 2017
Ian Harding 2017, 2018, 2019
Cartography: Ian Harding, Kevin Teschendorf

Whitetail Woods May 18 2019

	Red	8.3 km	200 m	entering
1	201			
2	202			
3	203	X		
4	204	✓	•	○
5	205	○	○	○
6	207	○	○	○
7	206	○	○	○
8	208	U		
9	209	○	○	○
10	210	○		
11	211	X		
12	212	↘	<	
13	213	↘		
14	232	↗	↑	
15	214	←	▲	○
16	215	↗	○	○
17	216	↘	○	○
18	217	↘	○	○
19	218	○		

entering

190 m

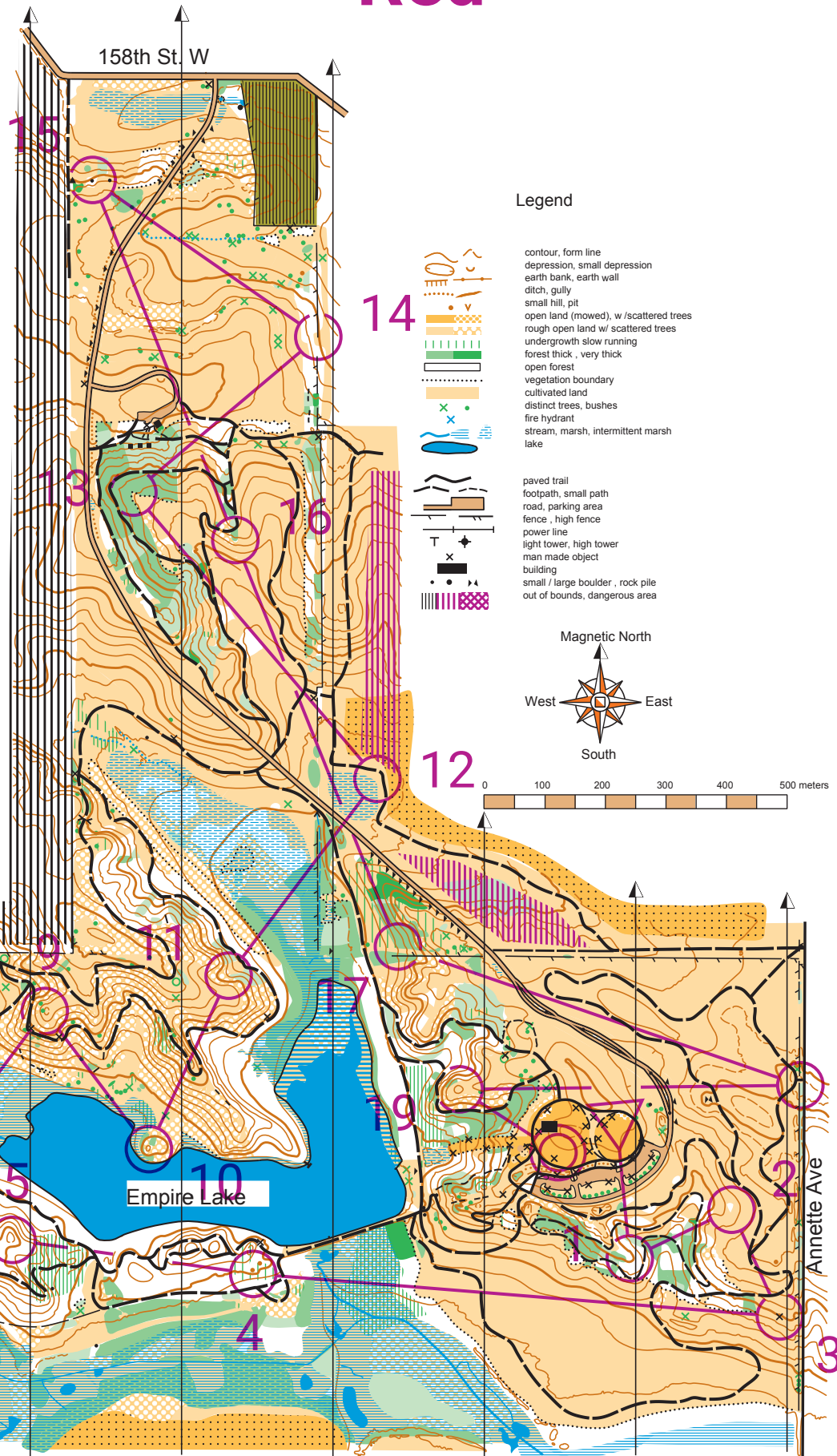

Legend

- contour, form line
- depression, small depression
- earth bank, earth wall
- ditch, gully
- small hill, pit
- open land (mowed), w/ scattered trees
- rough open land w/ scattered trees
- undergrowth slow running
- forest thick, very thick
- open forest
- vegetation boundary
- cultivated land
- distinct trees, bushes
- fire hydrant
- stream, marsh, intermittent marsh
- lake
- paved trail
- footpath, small path
- road, parking area
- fence, high fence
- power line
- light tower, high tower
- man made object
- building
- small / large boulder, rock pile
- out of bounds, dangerous area

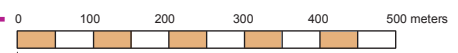
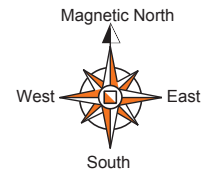

18

Annette Ave

3